





K Rend is the UK's largest independent silicone render manufacturer. With over 28 years bagged render manufacturing experience producing the market leading K Rend brand, they are committed to excellence, innovation and teamwork in providing you with the highest quality products and technical service support.

The K Rend brand represents excellence in:

## **HIGH QUALITY, EXTENSIVE PRODUCT RANGE**

## **EXPERT TECHNICAL SUPPORT**

## **INNOVATION**

K Rend external renders are designed to give a durable weatherproof coating and a natural finish.

# BUILDING ON OUR REPUTATION



K Rend Silicone TC 15, Pure White, Colchester.

## High Quality, Extensive Product Range

K Rend provide tailored products for demanding requirements. We hold the prestigious Kitemark license to BS EN 998:2010 and BS EN 15824. The Kitemark® is the world's premier symbol of trust, integrity and quality ensuring that vital product safety and performance requirements are met. Kitemark® schemes are voluntary, illustrating commitment to providing customers with the highest standard of quality products and service.

## Expert Technical Support

We provide a comprehensive technical support service by utilising over 28 years of experience and sharing it with you. Our expertly trained Technical Support Team are able to provide efficient detailed advice, specifications and on-site support.

## Innovation

Pride is taken in product innovation and developing new products. A continuous development process responds to ever-changing industry's needs and expectations. The K Rend manufacturing plant has some of the most advanced production facilities in Europe.

We take pride in innovative product design, however the impact on the environment is also important. Environmental considerations are an integral part of business practice. Therefore in developing the K Rend range, care has been taken to ensure that from the earliest stages of product design through to manufacturing, modern technologies have been utilised to help reduce our impact on the environment. Five areas of particular attention are:

## **RESPONSIBLE MANUFACTURING**

## **ENERGY EFFICIENCY & RECYCLING**

## **MONITORING BIODIVERSITY**

Kilwaughter Minerals Ltd's Environment Management System is certified to ISO 14001:2004.

Silicone FT, White, Hampshire.



# SILICONE TECHNOLOGY FOR WATER RESISTANCE THAT WORKS



**WATER REPELLENT**  
**LOW MAINTENANCE**  
**EXTENSIVE COLOUR RANGE**

The K Rend silicone range incorporates silicone water repellents as an integral part of the cement based render system. This silicone technology imparts a high degree of water repellency to the render surface whilst allowing water vapour to pass through

the render allowing the substrate to breathe. The water repellent surface ensures a freshly rendered appearance for a prolonged period. The finish is drier and thus more resistant to algae growth and the natural phenomenon of limebloom.

# PRODUCT RANGE

K Rend Silicone Thin Coat Product overview page 7 - 8	K Rend Textured Finish Product overview page 9 - 10	K Rend Dash Receiver Product overview page 11	K Rend Roughcast Product overview page 12
<p><b>Silicone TC 10</b> Hand applied</p> <p><b>Silicone TC 15</b> Hand applied</p> <p><b>Silicone TC 30</b> Hand applied</p> <p><b>Primer TC</b> Brush, roller or spray</p> <p><b>Mineral TC</b></p>	<p><b>Silicone FT</b> Hand applied</p> <p><b>Silicone K1</b> Spray or hand applied</p> <p><b>K1 Spray</b> Spray or hand applied</p>	<p><b>Silicone Dash</b> Hand applied</p> <p><b>Overcoating Silicone Dash</b> Spray or hand applied</p> <p><b>Silicone Spray Dash</b> Spray or hand applied</p>	<p><b>Silicone Roughcast</b> Hand applied</p>

Silicone K1, Arran, Hampshire.



Silicone TC 15 and TC 30, using bespoke colours from the NCS colour system, Dundee.



# K REND... THE PERFECT FINISH

K Rend Brick Rend Product overview page 13	K Bead Product overview page 14	K Rend Base Coat Product overview page 15	K Rend Complementary Products & Services
<p><b>Brick Rend</b> Hand applied</p>	<p><b>Durable uPVC Beads</b></p>	<p><b>Standard UF Base</b> Spray or hand applied</p> <p><b>HP12 Base</b> Spray or hand applied</p> <p><b>HP14 Base</b> Spray or hand applied</p> <p><b>HPX Base</b> Spray or hand applied</p>	<p><b>K Rend Product Training</b> see page 16</p> <p><b>K Rend Alkali Resistant Reinforcing Mesh</b> <b>K Pro</b></p> <p><b>R7 Acrylic</b> Bonding Aid</p> <p><b>R10</b> Bonding Aid</p>



**Accelerator**  
Liquid additive to accelerate curing time

**K RANGE**  
Also available:  
**K Mix Construction Mortars**  
**K Lime Natural Hydraulic Lime Mortars**  
**K Post**  
**K Rend Tyrolean**  
**K Rend Traditional White Mortar**

**Complementary Products:**  
Range of tools (see page 16)



K Rend offer an algae resistant additive which gives enhanced resistance against algae growth.

All additives are contained in the mix in powder form, therefore only clean water and thorough mixing are required. Please ask the Technical Support Centre for further advice.

In line with our policy of continuous product development, we reserve the right to change technical data without notice.



Silicone TC 15 and TC 30, using bespoke colours from the NCS colour system, Dundee.



Silicone FT, Polar White, Newry.

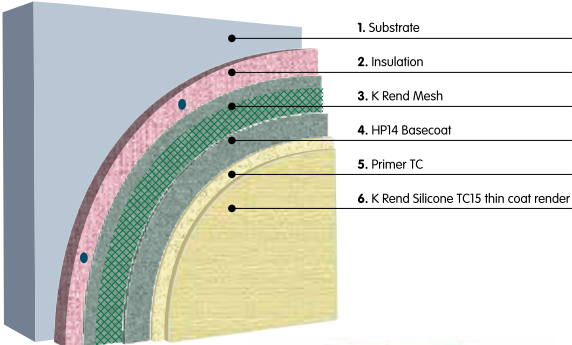

# SILICONE THIN COAT (TC)

Silicone TC	Primer TC	
<p>Silicone TC is a ready to use organic resin render which is applied to provide a low maintenance textured finish. It is available in different textures and a wide variety of colours. Prior to application the substrate should be primed using Primer TC.</p> <p><b>Require:</b>  <b>Silicone TC 10:</b> 1.8kg / sq m approx.  <b>Silicone TC 15:</b> 2.5 kg / sq m approx.  <b>Silicone TC 30:</b> 5.0 kg / sq m approx.</p> <p><b>Product classification according to BS EN 15824:2009</b>            Coating Material DIN 18558 – P Org 1</p> <p>A water-dilutable product for exterior and interior use.</p> <p>Water vapour permeability – Category V 2;            Water absorption – Category W 3;            Adhesion - 0.65 MPa;            Thermal Conductivity:  <math>\lambda</math> 10, dry (P=50%) = 0.83,  <math>\lambda</math> 10, dry (P=90%) = 0.93;</p> <p>Reaction to fire - Class B-s2,d0</p> <p><b>Product Classification (DIN 18558)</b>            Coating Material DIN 18558 – P Org 1</p>	<p>Primer TC is a low odour, ready to use primer which is quick and easy to apply by brush, roller or spray. It is available in a wide range of colours which are co-ordinated to the colour of the Silicone TC topcoat.</p> <p>Primer TC should be used after the application of K Rend base coat and before Silicone TC.</p> <p><b>Require:</b>  <b>Primer TC</b> – 0.25 kg / sq m approx.</p> <p><b>Composition:</b>            A water-dilutable Acrylic resin dispersion.</p> 	<p>The Thin Coat range is particularly suitable where lightweight render systems are required, such as an external wall insulation system (illustrated below).</p>   



All full colour illustrations shown in this brochure are as accurate as the printing process will allow. It is important that a sample is obtained as we recommend colours be verified against K Rend Thin Coat samples before ordering.



# MINERAL THIN COAT (TC)

## Mineral TC

Mineral TC is a cement based, polymer modified render, requiring only the addition of water and 10 minutes mixing time. It will provide an attractive, low maintenance finish and is available in two textures and four standard colours.

### Require:

**Mineral TC 2:** 2 - 2.5 kg / sq m approx.

**Mineral TC 4:** 4.5 - 5 kg / sq m approx.

### Kitemark Classifications:

Compressive Strength: CS III

Capillary water Absorption: W2

Thermal Conductivity: P=50% -0. 45



Pure White



Granite



Pearl



Wheaten



Silicone TC 15, Pearl, Co Antrim.

Silicone TC 15, Pure White and bespoke colours from the NCS Colours system, Somerset.



# SILICONE SCRAPED TEXTURE

Silicone FT	Silicone K1	LW1 Lightweight Render
<p>Silicone FT incorporates silicone technology and provides a fine texture finish.</p> <p><b>Require:</b> 32kg / sq m approx. nominal 16mm thickness</p> <p><b>Over Base Coat Require:</b> 18kg / sq m approx. nominal 10mm thickness</p> <p><b>Kitemark Classifications:</b> Compressive Strength: CS IV</p> <p><b>Capillary Water Absorption Category:</b> W2</p> <p><b>Thermal Conductivity:</b> P=50% -0.63</p>	<p>Silicone K1 incorporates silicone technology. It is suitable for use with most render spray machines. It is ideal for larger projects where the speed of machine application can offer time saving benefits. Suitable for hand application also.</p> <p><b>One coat Require:</b> 1.6 kg / mm thick / sq m nominal 16 - 20mm thickness</p> <p><b>Kitemark Classifications:</b> Compressive strength: CS II</p> <p><b>Capillary Water Absorption Category:</b> W2</p> <p><b>Thermal Conductivity:</b> P=50% - 0.39</p>	<p>K Rend LW1 is a lightweight, cement based and polymer modified self-coloured render, which can be applied directly onto a wide range of masonry and external wall insulation (EWI) substrates. K Rend LW1 can be used to achieve a variety of finishes.</p> <p><b>One coat Require:</b> 20 - 25kg / sq.m approx. on masonry substrates. Nominal 16-20mm thickness for masonry substrates. (Minimum finished render thickness = 16mm)</p> <p>15 - 20kg / sq.m approx. on insulation substrates. Nominal 12-16mm thickness for insulation substrates. (Minimum finished render thickness = 12mm)</p> <p><b>Kitemark Classifications:</b> Compressive strength: CS III</p> <p><b>Capillary Water Absorption Category:</b> W2</p> <p><b>Thermal Conductivity:</b> P=50% - 0.30</p>



K Rend silicone scraped texture renders form an attractive range of one coat applications plastered directly on to block work. They should also be used as a finish in conjunction with a K Rend Base Coat.

To achieve the required finish, float to a level surface then scrape the complete surface evenly with a scraping tool when the render is set but not hard, removing 2mm, to produce a uniform texture.

This type of application is suitable for Ashlar cutting.



Silicone FT

### Plastering Test Panel

For all products it is recommended that a test panel (ideally 2m<sup>2</sup>) be produced for inspection by the customer (client, architect, etc.). Work should not commence until the customer is satisfied with the texture and general appearance of the product. The test panel should be prepared well in advance of work commencing. Applicators should be familiar with product water requirement, handling characteristics, setting and hardening times. These may vary according to background, temperature and humidity.

NOTE: For all products "Require" figures are approximate, take no account of wastage and may vary according to substrate and application technique.

K Rend is manufactured using natural raw materials. Subtle texture and colour variations may occur during the application process. It is recommended products are selected from actual samples. Large site samples are available which can be applied under normal site conditions to give a representative sample.

### Textured Finish 1 Coat (2 passes)

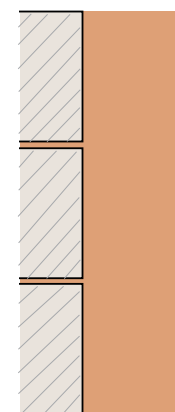

Finish coat 16 mm

### Textured Finish 2 Coats

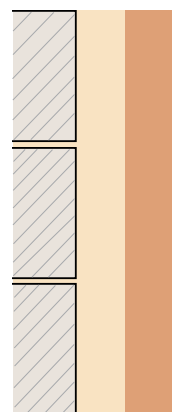

Base coat 10 mm  
Finish coat 10 mm

Please seek advice from our Technical Support Centre for a detailed specification.

# ...THE PERFECT FINISH

## K1 Spray

K1 Spray is designed for use with most render spray machines. It is ideal for larger projects where the speed of machine application can offer time saving benefits. Suitable for hand application also.

### One coat Require:

26 - 32kg / sq m approx.  
nominal 16 - 20mm thickness

### Kitemark Classifications:

Compressive Strength: CS II

Capillary Water Absorption  
Category: W2

Thermal Conductivity:

P=50% - 0.44

## Silicone Scraped Texture Standard 20 Colours



White\*



Buttermilk



Polar White\*



Stone



Champagne



York



Cream\*



Powder Blue



Salmon Pink



Pewter Grey



Terracotta



Grey



Ivory



Sterling White



Arran



Sandstone



Green



Oatmeal



Cinnamon



Fintry Stone

## COLOUR NOTE

\* White is the brightest white within the Scraped Texture range, however it is not brilliant white

\* Polar White is an off white shade

\* Cream has a yellow tone to it

Above: 20 standard Scraped Texture colours. Special colours are available from a customisable pallet, upon request from our Technical Support Centre.

All full colour illustrations shown in this brochure are as accurate as the printing process will allow. It is important that a sample is obtained as we recommend colours be verified against K Rend Scraped Texture samples before ordering.

Silicone FT, Polar White, Co. Londonderry.



# SILICONE DASH RECEIVER

Silicone Dash	Overcoating Silicone Dash	Silicone Spray Dash
<p>Incorporating silicone technology, Silicone Dash is normally applied over K Rend Base Coats as a background surface for dry dash or roughcast finishes.</p> <p><b>Require:</b> 10-15kg / sq m approx. nominal 6-10mm thickness</p> <p><b>🏆 Kitemark Classifications:</b> <b>Compressive Strength:</b> CS III <b>Capillary Water Absorption Category:</b> W2 <b>Thermal Conductivity:</b> P=50% -0.47</p>	<p>Specifically designed for refurbishment, Overcoating Silicone Dash is light and easy to use and gives excellent coverage over existing dry dash finishes. Surfaces to be over coated should be free from contamination (algae, oil and paint) and may require priming with R7 liquid acrylic prior to application.</p> <p><b>Require:</b> 8-10kg / sq m approx. nominal 8-10mm thickness</p> <p><b>🏆 Kitemark Classifications:</b> <b>Compressive Strength:</b> CS II <b>Capillary Water Absorption Category:</b> W2 <b>Thermal Conductivity:</b> P=50% - 0.26</p>	<p>This silicone enhanced dash receiver is designed to be spray applied by machine to increase the speed of application. Normally applied over a K Rend Base Coat, providing a surface for dry dash finishes.</p> <p><b>Require:</b> 10-15kg / sq m approx. nominal 6-10mm thickness</p> <p><b>🏆 Kitemark Classifications:</b> <b>Compressive Strength:</b> CS III <b>Capillary Water Absorption Category:</b> W2 <b>Thermal Conductivity:</b> P=50% -0.45</p>



Silicone Dash Receiver, Ivory, Co. Down.

K Rend Silicone Dash receivers are used over K Rend Base Coats. They are polymer modified and through coloured. These products are designed to have excellent workability and open time properties when used as backgrounds for 4-12mm dry dash or roughcast finishes. The finished thickness is normally determined by the size of the aggregate. Apply a uniform butter coat and throw the aggregate onto the surface while the render is still green.

**Dash receiver**

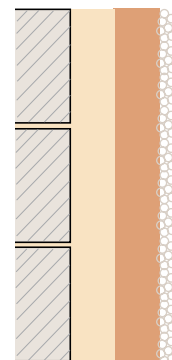

Base coat 8-10mm  
Dash receiver 8mm  
Dry dash

Please seek advice from our Technical Support Centre for a detailed specification.

# SILICONE ROUGHCAST (Wet dash)

## Silicone Roughcast

Silicone Roughcast incorporates silicone technology to give excellent water resistant qualities. It is applied over a Silicone Dash receiver.

**Dash receiver require:**

9-12kg / sq m approx.  
nominal 6-8mm thickness

**Roughcast require:**

8-13kg / sq m approx.

**Kitemark Classifications:**

**Compressive Strength:** CS IV

**Capillary Water Absorption**

**Category:** W2

**Thermal Conductivity:**

P=50% - 1.03



Silicone Roughcast, Sterling White, Aberdeen.



Silicone Roughcast, Ivory, Co. Down.



K Rend Silicone Roughcast may be used as an alternative to dry dash, providing an attractive through coloured render finish. Base Coat is first applied to the blockwork, when a receiving coat of dash receiver is still green, throw Roughcast onto the surface. The dash receiver and Roughcast must be the same colour.

**Roughcast**

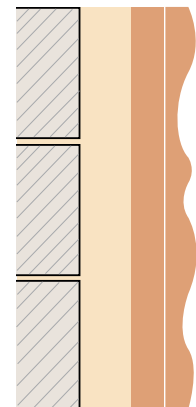

Base coat 8-10mm  
Dash receiver nominal 6mm  
Roughcast

Please seek advice from our Technical Support Centre for a detailed specification.

# BRICK REND (Brick effect render)

## Brick Rend

Brick Rend provides the benefits of flexibility and water resistance. This render is ideal as part of an external wall insulation system.

**Mortar Layer Require:**  
10-15kg / sq m approx.  
nominal 6-8mm thickness

**Face Layer Require:**  
5-10kg / sq m approx.  
nominal 3-5mm thickness

**Kitemark Classifications:**  
Compressive Strength: CS IV

Capillary Water Absorption  
Category: W2

Thermal Conductivity:  
P=50% - 0.44

### Brick Rend

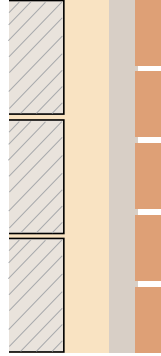

Base coat 8-10 mm  
Mortar coat 8 mm  
Brick coat 3-5 mm

K Rend Brick Rend is an attractive brick effect render, particularly suitable for refurbishment projects where new brick work cannot be used. It is normally applied to K Rend Base Coats in two different coloured coats, wet on wet. The top coat is then cut through to expose the mortar layer. The mortar joints create a brick effect finish.

Detailed guidance and assistance including site training and samples can be arranged on request. Please seek advice from our Technical Support Centre for a detailed specification.



Brick Rend Application

Below: A sample of Brick Rend colours available. Special colours can be created upon request.



**Mortar Coat:** Keighly Grey  
**Brick Coat:** Orian Red



**Mortar Coat:** Light Grey  
**Brick Coat:** Carmel



**Mortar Coat:** Light Grey  
**Brick Coat:** Winchet Red



**Mortar Coat:** Mellow Grey  
**Brick Coat:** Stockport Red

All full colour illustrations shown in this brochure are as accurate as the printing process will allow. It is important that a sample is obtained as we recommend colours be verified against K Rend Brick Rend samples before ordering.

## K Rend K Pro

A water based protective treatment used to provide long term enhanced water repellent properties to external render and other masonry surfaces. It can help combat the problems associated with water intrusion including efflorescence, frost, water-soluble pollutants and algae growth. It provides increased resistance to oil absorption enabling the substrate to stay clean and dry for longer.



Available in 25L jars.

## K Rend R7 Acrylic

A modified acrylic emulsion used to improve the adhesion of K Rend renders to difficult substrates, where the background does not provide sufficient key or has poor suction characteristics. The material is usually diluted before use and may be used in various ways, including as a priming coat, as a gauging liquid and to prepare polymer modified stipple coats.



Available in 5kg or 25kg jars.

## K Rend R10

K Rend R10 is a modified acrylic bonding coat designed to improve the adhesion of K Rend renders to difficult substrates, where the background does not provide sufficient key or has poor suction characteristics. It can improve a difficult substrate and prepare the background for application of K Rend one coat renders.



Available in 20kg buckets.

## K Rend Accelerator

A liquid additive used to reduce the waiting time before scraping K Rend scraped texture renders. It accelerates the curing time meaning that the render may be scraped earlier, enabling a faster job completion. It may be used in cold conditions to improve the scraping time (however all winter working precautions still apply). It has no effect on the appearance of the render.



Available in 20L jars.

# K BEAD

## K Bead Durable uPVC Beads

K Bead is a range of durable uPVC beads designed to be used with all K Rend renders. They are ideal for damp, wet or corrosive environments or where plaster drying times may be extended.

K Bead's are produced to the highest quality standards and checks at time of manufacture. They are fully compliant with European building regulation and the international Quality system ISO 9001:2000.

### Performance benefits

K Bead is a tough performing range of beads. They are easy to handle, safe to cut and simple to apply, with little or no waste.

All beads within the range have a raised aris, making them ideal for both scraped and floated finishes and helps applicators apply surface finish to an exact crisp point.

K Bead have a high resistance to corrosion, staining and impact.

### Colour options

In addition to the K Bead standard range of white and ivory beads, a choice of coloured beads is available upon request.

Minimum order quantities may apply.

Please contact our Technical Support Centre for more information.



Stop Bead (available in 4, 6, 8, 11 & 15 mm)



Expansion Bead



Drip Bead



Angle Bead (available in 4, 6, 8, 11 & 15 mm)



Bellcast Bead

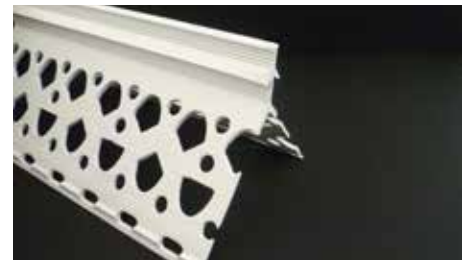

New Heavy Duty Angle Bead

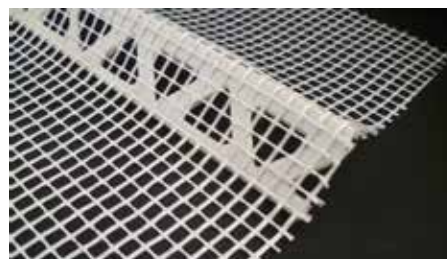

Impact Bead with Mesh



Angle Bead with Mesh

## K Rend Alkali Resistant Reinforcing Mesh

K Rend Alkali Resistant Reinforcing Mesh (50m roll) is used to reduce the build up of stress at typical stress points in the building, thus minimising the potential for cracking.

- Used to reinforce the basecoat
- Simple to install
- Use with all K Rend renders
- Alkali resistant
- Improves crack resistance
- Inhibits building movement
- Improves impact resistance



Standard UF Base	HP12 Base	HP14 Base	HPX Base
<p>A high quality general purpose sprayable base coat with excellent workability qualities, designed to be used over block work as a primary coat for K Rend finishes and is ideal as the background for thin coat acrylic finishes.</p> <p><b>Coverage:</b> 1.8kg / mm thick / sq m</p> <p><b>Require:</b> 14-18kg / sq m approx. nominal 8-10mm thickness</p> <p><b>🏆 Kitemark Classifications:</b> Compressive Strength: CS IV Capillary Water Absorption Category: W2 Thermal Conductivity: P=50% - 0.43</p>	<p>HP12 Base uses 'High Polymer' technology for a cost effective, enhanced performance on difficult substrates. It is ideal as a stipple coat or for dense backgrounds and has increased water resistance and adhesion. Incorporation of Alkali Resistant Reinforcing Mesh may be required.</p> <p><b>Coverage:</b> 1.8kg / mm thick / sq m</p> <p><b>Require:</b> 8-11kg / sq m approx. nominal 4-6mm thickness</p> <p><b>🏆 Kitemark Classifications:</b> Compressive Strength: CS IV Capillary Water Absorption Category: W2 Thermal Conductivity: P=50% - 0.72</p>	<p>HP 14 Base uses "High Polymer" technology for a cost effective, enhanced performance onto a wide variety of substrates. It is designed as the ideal background for thin coat organic resin render such as Silicone TC.</p> <p><b>Coverage:</b> 1.8kg / mm thick / sq m</p> <p><b>Require:</b> 8-11kg / sq m approx. nominal 4-6mm thickness</p> <p><b>🏆 Kitemark Classifications:</b> Compressive Strength: CS II Capillary Water Absorption Category: W2 Thermal Conductivity: P=50% - 0.41</p>	<p>Ultra high performance render incorporating high polymer technology and fibres. Used on unusual substrates requiring greater flexibility and adhesion, often incorporating an Alkali Resistant Reinforcing Mesh.</p> <p><b>Coverage:</b> 1.5kg / mm thick / sq m</p> <p><b>Require:</b> 6-9kg / sq m approx. nominal 4-6mm thickness</p> <p><b>🏆 Kitemark Classifications:</b> Compressive Strength: CS III Capillary Water Absorption Category: W2 Thermal Conductivity: P=50% - 0.36</p>

All Base Coats can be hand or spray applied.



K Rend Base (Scratch) Coats are polymer modified and cement based to ensure flexibility and strength. Scratch coats require only the addition of water and five minutes mixing time. Normally applied in one coat as a backing for K Rend finishes. Rule off to a flat finish and scratch lightly to provide a key for the next coat.

For unusual substrates, seek technical advice.

**Base Coat**

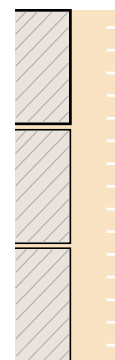

Base coat  
4-10mm

(depending on product)

Silicone TC 15, Pure White, Colchester.





# TOOLS

## K Rend Tools

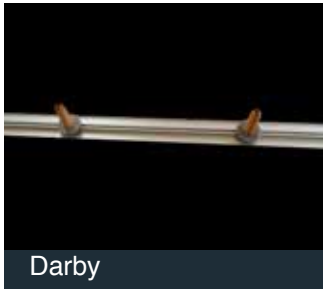

**Darby**

Heavyweight flat section with adjustable handles, used to smooth and straighten final render finishes.



**TC Float**

Used for rubbing up thin coat products including TC10, 15, 30 and Mineral TC.



**K Rend Scraper**

Used to give renders a scraped textured finish. The surface is scraped back exposing some of the aggregate and leaving a more decorative finish.

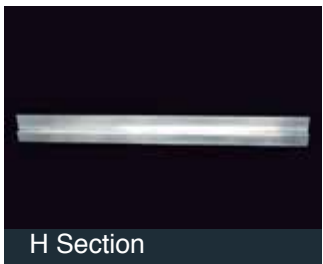

**H Section**

Aluminum straight edge, used to straighten the basecoat or render surface.



**I Section**

Aluminum straight edge, used for scraping back render prior to scraping.

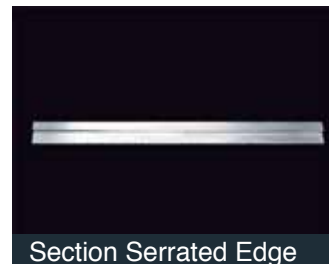

**Section Serrated Edge**

Aluminum serrated edged, used for leveling render and to remove any trapped pockets of air.



**22" Spatula**

Stainless steel blade for finishing and smoothing render.



**Ashlar Cutter**

Used to create a decorative recessed joint into the finished textured render to replicate the appearance of traditional ashlar masonry.

## K Rend Centre Of Excellence Training

K Rend offer Product Training at the Centre of Excellence, Larne, N. Ireland. The one day course is open to anyone. It is 75% hands-on training and 25% classroom technical learning.

On completion you receive:

- K Rend Certificate
- Samples & Literature Pack
- Technical Presentation
- Hi-vis Vest
- Pen & Van Livery
- Opportunity to become a 'Recommended K Rend Applicator'

Airport transfers are free of charge. Breakfast & lunch are provided.

Courses run monthly throughout the year.

For available dates contact:

**E: [ProductTraining@Kilwaughter.com](mailto:ProductTraining@Kilwaughter.com)**

**T: 028 2826 0766**



RESEARCH	DESIGN & SPECIFICATION		ARCHITECT INFORMATION
<p>Research and development is a continuous process that provides new answers to the changing needs and expectations of customers. Driven by market requirements and the emerging opportunities presented through the development of new technology, K Rend are committed to excellence in providing new innovative products.</p> <p>A team of Chemists and Technicians conduct extensive prototype testing on all new product designs whilst continuously assessing potential improvements to existing products by utilising innovative technologies. This keeps K Rend up to date with all new requirements including product performance, legislation and building design.</p>	<p>Technical advice &amp; specifications are available on Tel: 028 2826 0766</p> <p>K Rend external renders are designed to give a durable weatherproof coating and a natural finish. A low maintenance finish will add value to any building. To maximise the benefits of K Rend, the following points may be considered in designing a render finish. Water should be prevented from continually running down facades. A generous overhang or eave should be designed together with sufficient drips at all sills and copings.</p> <p><b>Angles</b> Angles may be formed using K Bead PVC angle and stop beads.</p> <p><b>Expansion Joints</b> Render expansion joints must follow structural movement breaks. For other expansion joints refer to BS EN 13914:2005.</p> <p>A detailed instruction leaflet and health and safety information are enclosed with every pallet of render.</p>	<p>Some construction materials may be susceptible to alkali attack; fittings and surfaces adjacent that are likely to be damaged during rendering should be protected.</p>	<p><b>Specification</b> K Rend is a member of the Royal Institute of British Architects' 'National Building Specification Plus' system. Please visit <a href="http://www.thenbs.com">www.thenbs.com</a> to create a specification. Alternatively visit the Specification Writer on our website: <a href="http://www.K-Rend.co.uk">www.K-Rend.co.uk</a></p> <p><b>Continuous Professional Development (CPD)</b> K Rend offer Architects RIBA CPD approved training via 2 seminars:</p> <ul style="list-style-type: none"> <li>• New British Standards for External Render</li> <li>• Principles of Render Application Over Masonry Substrates</li> </ul> <p>This seminar counts towards Architects RIBA CPD annual training requirement. Seminars are also open to other contractors. Please contact us to arrange a seminar at your premises:</p> <p><b>E: <a href="mailto:CPD@Kilwaughter.com">CPD@Kilwaughter.com</a></b> <b>T: 028 2826 0766</b></p>

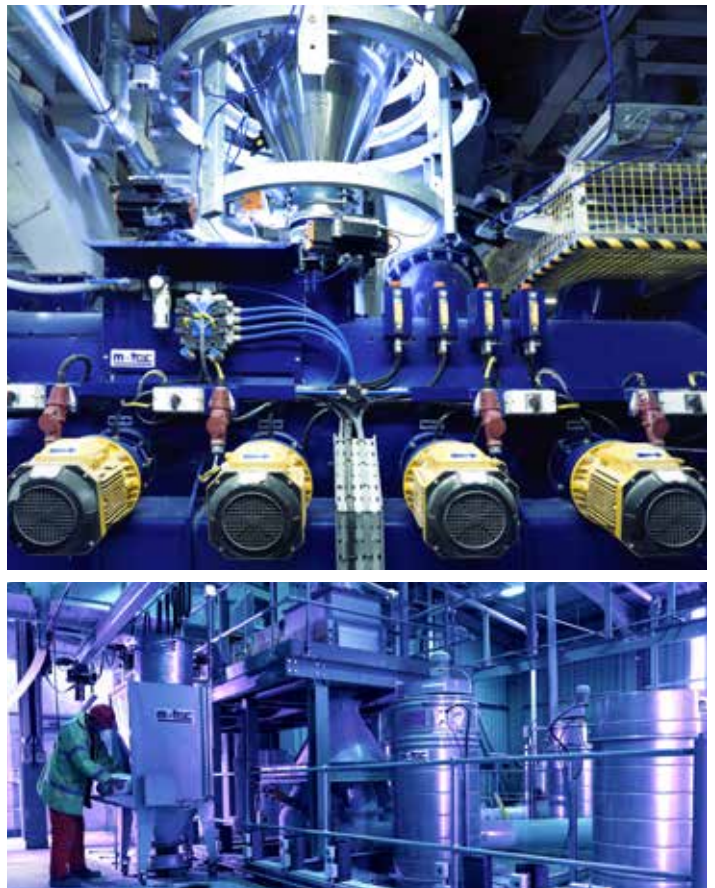

# GENERAL INSTRUCTIONS DESIGN & MAINTENANCE

BUILDING		MAINTENANCE	K RANGE
<p><b>Packaging</b></p> <p>K Rend bagged renders are normally packed in 25kg sacks, 40 sacks per 1 tonne pallet.</p> <p>K Rend Thin coat renders are normally packed in 25kg tubs, 40 tubs per tonne, loaded 30 per 750 kg pallet.</p> <p>All render sacks and tubs must be protected from frost and direct sunlight on site. Shelf life is approximately 1 year if stored in dry conditions, protected from frost and sunlight, in original unopened packaging, from date of manufacture.</p> <p>It is important to note that all K Rend renders are non-returnable.</p> <p><b>Site conditions</b></p> <p>Temperature range 5°C - 35°C K Rend renders must not be applied to frozen or thawing supports. If the coating must be applied in adverse weather conditions, it is essential to protect both the working area and finish before and after application.</p> <p>Areas between day work beads should be applied without a break.</p> <p>All areas of the building should be protected from rainwater for at least 24 hours after application of K Rend.</p>	<p>Do not allow down-pipes, sills and scaffolding to throw water on to setting render.</p> <p>Ensure that all copings and sills have sufficient drips to prevent any runs down the facade. This includes a drip cut under all mortar joints between copings.</p> <p>To prevent the appearance of lime-bloom, do not render in cold, damp weather.</p> <p>K Rend render, in common with all finishes, should be protected from all potential on site damage.</p> <p><b>Scraped texture</b> - to achieve a uniform colour, all areas must be scraped at the same stage of readiness or hardness.</p> <p><b>Roughcast finish</b> - do not go back over cured areas to fill in misses, as this can lead to inconsistency of colour.</p>	<p>Where general staining occurs, a warm power wash with a suitable detergent can be used to clean up the K Rend finish.</p> <p>Care must be taken to adjust the pressure of the power washer to ensure that the render surface is not damaged during the procedure (this is not suitable for dry dash finishes).</p> <p>An annual coat of fungicidal wash such as Algae Clean can prevent algae from growing on weather prevailing facades, which can be prone to algae by remaining wet over long periods.</p> <p>For additional, long term protection, particularly in weather prevailing areas, two coats of K Rend K Pro are recommended. Please ask the Technical Support Team for further advice.</p> <p>K Rend is compatible with a range of anti-graffiti treatments, call our Technical Support Team for advice.</p> <p>If a change of colour is required at a later date, K Rend is a suitable substrate for a good quality masonry paint.</p>	<p><b>K Rend Alkali Resistant Reinforcing Mesh</b> <b>K Pro</b></p> <p><b>R7 Acrylic Bonding Aid</b></p> <p><b>R10 Bonding Aid</b></p> <p><b>Accelerator</b> <b>Liquid additive to accelerate curing time</b></p> <p><b>K Mix Construction Mortars</b> <b>K Lime Natural Hydraulic Lime</b> <b>K Post</b></p> <p><b>K Rend Tyrolean</b> <b>K Rend Traditional White Mortar</b></p> <p><b>Complementary Products:</b> Range of tools Alkali Resistant Reinforcing Mesh Please call our Technical Support Team for further information. In line with our policy of continuous product development, we reserve the right to change technical data without notice.</p>



K Rend Manufacturing Facility



One Company... Two Divisions

[www.K-Rend.co.uk](http://www.K-Rend.co.uk)



**Construction**

Silicone Coloured Renders & Construction Mortars



**Agriculture & Landscaping**

Calcium Carbonate Powders, Limestone Sands, Aggregates & Minerals and Landscaping products

Join us on social media...



@KRendRenders



@KRendRenders



/KRendRenders



K Rend



@KRendRenders

